

Weber DCOE Idle Jets

The "F" code indicates the number and diameter of air holes.
The prefix (i.e. 55) indicates the diameter of the fuel hole (T).

Example:

55F17

Diameter T: 0.55 mm

Diameter B: 2.10 mm

2 Air Holes with a diameter of 1.35 mm each

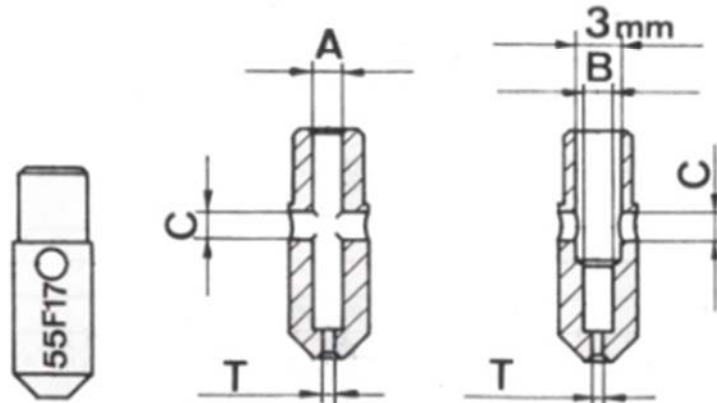

#

Basic Part Number	Type	A	B	C	
		Ø (mm.)	Ø (mm.)	Nr. holes	Ø (mm.)
74814. ...	F1	1.40		2	1.40
74815. ...	F2	1.50		1	1.40
74816. ...	F3	1.40		2	1.60
74817. ...	F4	2.00		1	1.40
74818. ...	F5	1.40		1	1.60
74819. ...	F6	2.00		1	0.70
74820. ...	F7	2.00		2	1.20
74821. ...	F8	2.00		1	1.20
74822. ...	F9	2.00		1	1.00
74824. ...	F11	1.50		1	1.20
74825. ...	F12	1.50		1	0.90
74826. ...	F13	2.00		2	0.90
74827. ...	F14	1.70		1	1.20
74828. ...	F15	2.00		2	1.05
74829. ...	F16	2.10		2	1.30
74830. ...	F17		2.10	2	1.35
74831. ...	F18		2.10	2	1.60
74832. ...	F19		2.00	1	1.20
74833. ...	F21		2.10	4	1.10
74834. ...	F22		2.10	4	1.20
74835. ...	F23		2.00	1	1.25
74836. ...	F24		2.00	1	1.55
74837. ...	F25		2.00	1	1.50
74838. ...	F26		2.00	2	1.25
74839. ...	F27		2.00	1	1.60

#